



LowTank Mobile Tanker Access System

Mobile Fall Prevention Solutions

Prevent falls from height when working on the back of ISO tank containers.

Features and Benefits

- Fixed three rail safety cage helps prevent operators from falling from back or sides of trailers
- Long cage sides ensure whole of working area is covered
- Safety clip and cords to secure cage sides to tank container
- Extra wide stairs make carrying hoses or specialist PPE easy and trip-free
- Single person operation allows easy positioning and access
- Large castor wheels ensure good operation on uneven ground
- Provides safe working area
- Increases operator confidence

Uses Include

- Tank container loading and unloading
- Accessing tank container ladders
- Working on the back of trucks, skeletal trailers, and flat bed trailers

Meets All Health and Safety Requirements for Operator Safety When Working At Height.



LowTank Mobile Access Ladder Technical Data

Materials

Frame and cage: Mild steel

Finish: Corrosion resistant powder coated

Castors: 200mm Solid rubber with sealed bearings

Carabiners: Stainless steel with plastic-coated steel cords

Dimensions

Top step height: 1.166m

Safety cage area: 2.06m long x 2.47m wide

Safety cage height: 1.2m

Access step width: 800mm

Ground clearance: 150mm

Stability

Cage designed to free stand or can be connected to side of tank containers for additional support

Wheel diameter: 200mm

Operation

Safe single operator use and access

Max. safe working weight limit: 150kg

Rear castors fitted with foot-operated brakes

Spring loaded safety gate at top of steps

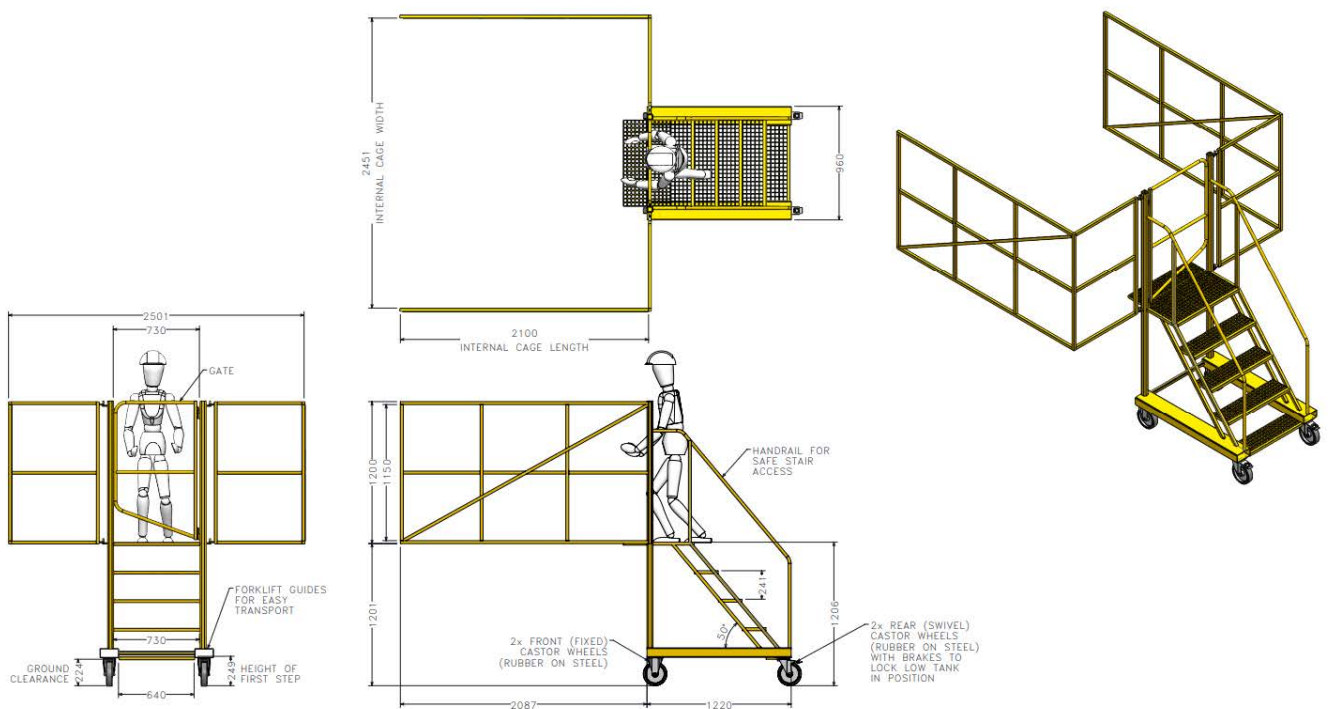

IFC Inflow

Liquid Loading & Safe Tanker Access

LEADERS IN SAFE TANKER ACCESS

www.ifcinflow.com | +44 (0)1268 596 900 | sales@ifcinflow.com

